

AX61120TP

1U Rackmount Chassis

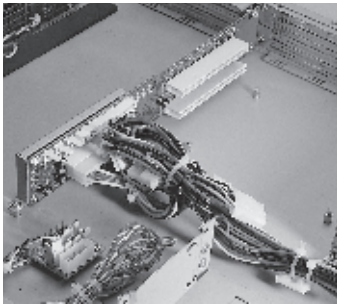

Built-in a butterfly backplane with 2 expansion slots

Features

- PICMG 1.3 SBC structure with 2 expansion slots
- Internal two 3.5" HDD drive bays
- Slim-line CD-ROM disk bay for ease of system installation
- Special cooling system design for supporting Intel® Pentium® 4 processor
- ATX 270W power supply (with PFC) for Intel® Pentium® 4 SBCs

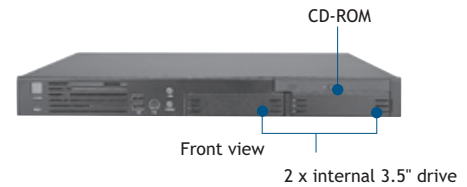

Rear view

Specifications

Standard Color	Black	Expansion Interface	2 x PCI card (half-size)
Construction	Heavy-duty cold-rolled steel	Operating Temperature Range	0°C - 40°C (32°F - 104°F)
Drive Capacity	Exposed 1 x slim-line CD-ROM Internal 2 x 3.5" HDD drive bay	Dimensions	482.6 mm (19") (W) x 500 mm (19.7") (D) x 44.3 mm (1.75") (H)
Cooling	3 x 4 cm ball bearing fan	Weight (net/gross)	9.8 kg (21.6 lb)/10.5 kg (23.15 lb)
Front Panel Indicators	1 x power on/off, 1 x HDD		
Front Panel Controls	1 x power on/off and 1 x system reset		
Front Panel Connectors	2 x USB, 1 x PS/2 6-pin		
Pre-punched Panel	Rear 1 x 9-pin, 1 x 25-pin		
System Board	Full-size SBCs		

Power Supply Specifications

Items	Watt	Specifications		
		Input	Output	MTBF
PS180-1U	ATX 180W (PFC)	AC 90-264V (Auto)	+5V @ 16A +12V @ 14A +3.3V @ 10A -12V @ 0.8A +5Vsb @ 2A	100,000 hours
PS270-1U	ATX 270W (PFC)	AC 90-264V (Auto)	+5V @ 18A +12V 1 @ 16A +12V 2 @ 10A +3.3V @ 16A -12V @ 0.8A +5Vsb @ 2.5A	100,000 hours
PS200-1U	ATX 200W (PFC)	AC 90-264V (Auto)	+5V @ 17A +12V 1 @ 6A +12V 2 @ 12A +3.3V @ 14A -12V @ 0.8A +5Vsb @ 2A	100,000 hours

Ordering Information

AX61120TP/X180	With ATX6022/3VP2, ATX 180W power supply
AX61120TP/X200	With ATX6022/3VP2 ,ATX 200W power supply
AX61120TP/X270	With ATX6022/3VP2, ATX 270W power supply
AX61120TP/X180	With FAB102, ATX 180W power supply
AX61120TP/X200	With FAB102, ATX 200W power supply
AX61120TP/X270	With FAB102, ATX 270W power supply

*Specifications and certifications are based on options and may vary.

Dimensions

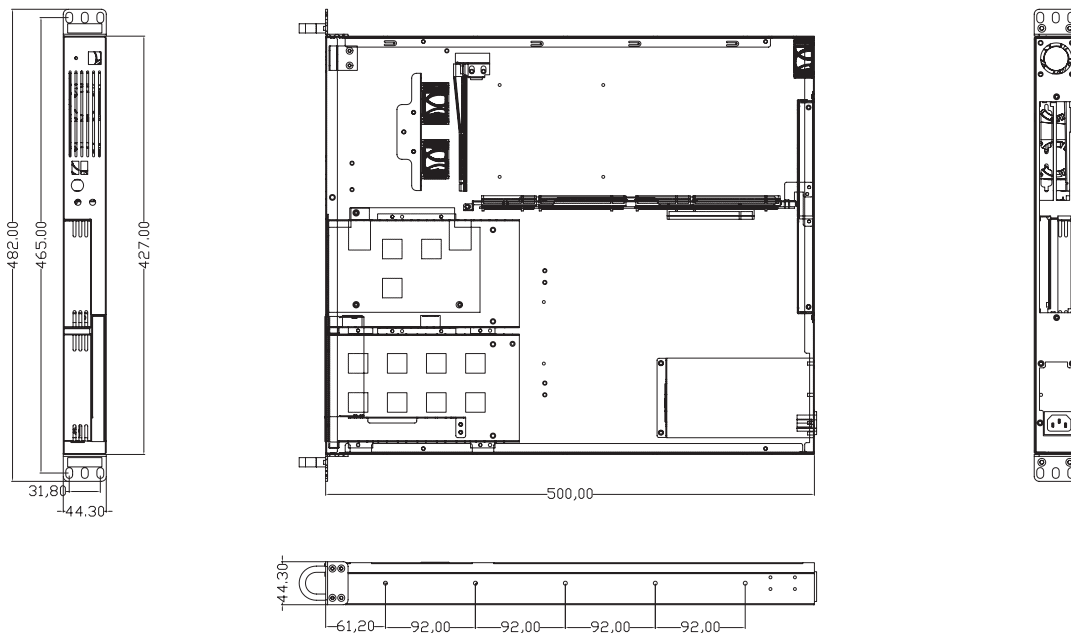

Recommended SBC Selections

- SBC81203 series w/ LGA775 heatsink
- SBC81205 series w/ LGA775 heatsink
- SBC81206 series w/ LGA775 heatsink
- SHB100 series w/ LGA775 heatsink (manufacture option)
- SHB103 w/ LGA1156 heatsink
- SHB110 series w/ LGA775 heatsink (manufacture option)

Backplane Options

PICMG 1.0

Models	Slots per Segment (ISA/PCI/PCIe/CPU)	Segment
ATX6022/3VP2	0/2/0/1	Single

PICMG 1.3

Models	Slots per Segment (ISA/PCI/PCIe/CPU)	Segment
FAB102	0/0/1/1	Single

Embedded Systems

Embedded Field Controllers

Embedded MicroBoxes

Industrial Barebone Systems

Industrial Chassis

Industrial Workstations

Backplanes

Power Supplies

Peripherals & Accessories